

# Lake Pertobe — Stage Three

We are seeking

**\$4 million to deliver the next stage of a master plan that will ensure Lake Pertobe remains an iconic city park that is a major visitor drawcard and a recreational and social space that can be enjoyed and accessed by all residents.**

Lake Pertobe is 58ha park nestled between Warrnambool's CBD and the beachfront.

The lakes within Lake Pertobe are a haven for native birds while the play and recreational spaces are a major drawcard for visitors and residents.

Over nearly five decades Lake Pertobe has established itself as one of Warrnambool's most recognised visitor attractions. In 2018 the Lake Pertobe Master Plan, developed in consultation with the community, identified the need for priority works that would meet contemporary expectations and provide all-abilities access to more of the park and its features.

The implementation of the plan began with a comprehensive upgrade of Play Area 1 and Play Area 2 and the construction of all-abilities access toilets and a Changing Places facility.

Council is now focused on Play Area 3 at the south-west section of Lake Pertobe where Immediate or high priority works include design and developing a diverse range of exciting, unique, challenging and innovative all-ages play opportunities.

Access will be improved with the removal of barriers such as raised timber edges and sand soft fall and replacing them with accessible pathways and surfaces.

Replacement of an ageing swing bridge is also included in this stage along with high quality 2.5m wide paths which connect event spaces within this section of Lake Pertobe.

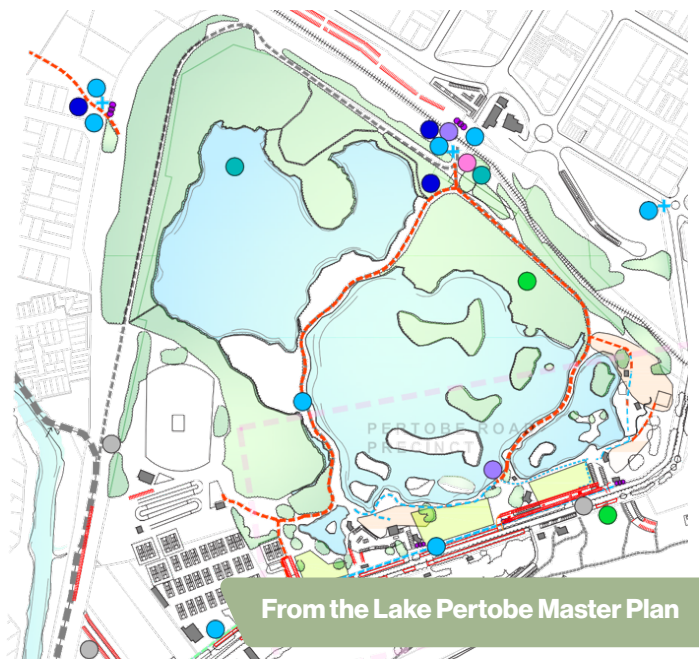

## Contact

**Andrew Mason**  
Chief Executive Officer  
Warrnambool City Council

✉ [amason@warrnambool.vic.gov.au](mailto:amason@warrnambool.vic.gov.au)  
☎ 5559 4800